

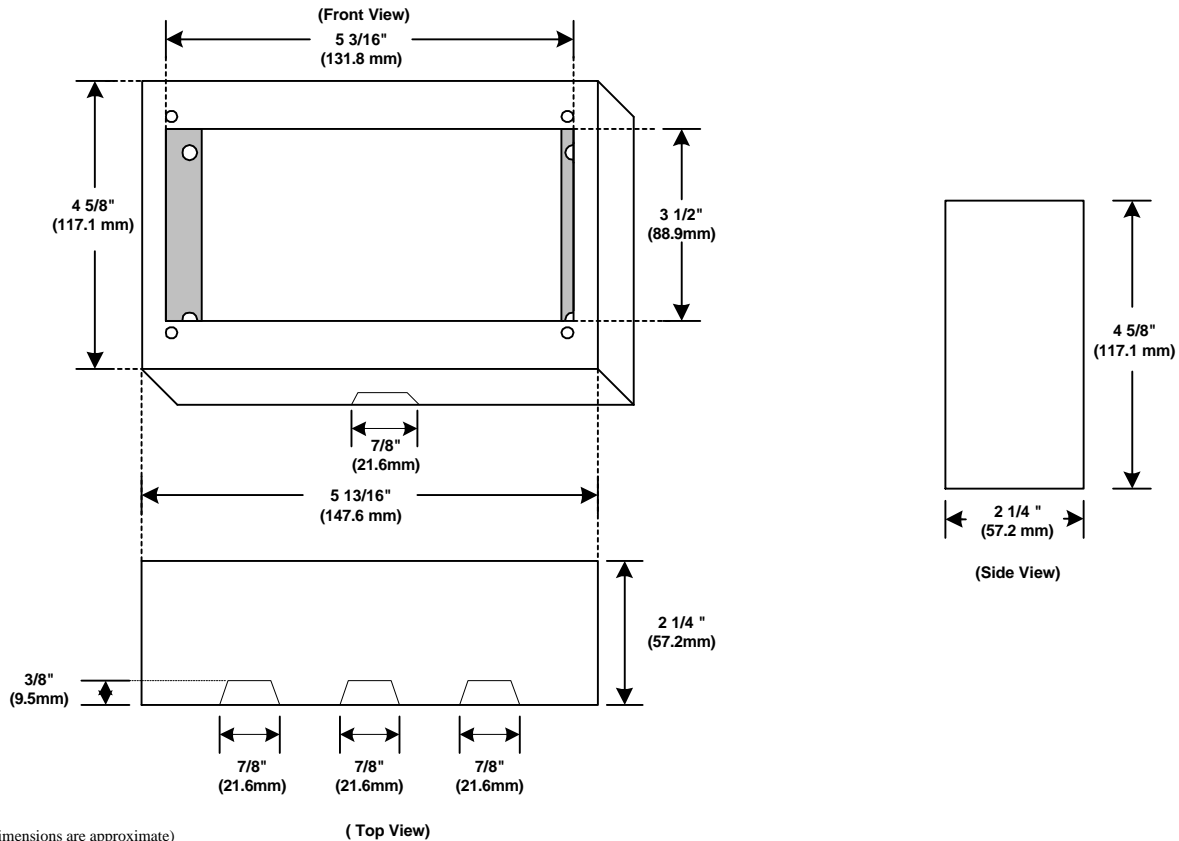

# Surface Mount Box

## Part # 401



### Features

- Baked Enamel Finish
- Four (4) Easy Knock Outs
- Accommodates 400 Series Wiremold

### Material Included

Surface Mount Box	1
Screws and Anchors	4

### Description

This 401 Surface Mount Box is a custom made enclosure and can be used with several components. This box is typically used where the walls are made of cement or in an installation where the Flush Mount Box is not practical.

### Specifications

Construction	Steel w/ Baked Enamel Finish
Mounting	Four (4) Screws w/ Anchors
Usage	ADV 500DE, ADV 1000, ADV 1000DE, and 203